

# Walking Star Quilt Block

Star Quilt Block of the Month Block #3 Walking Star

NOTE: Lighter shade of color indicates wrong side of fabric.

Diagram 1

Use Two 4 1/8" Fabric A and D squares from Half Square Triangle Bag.

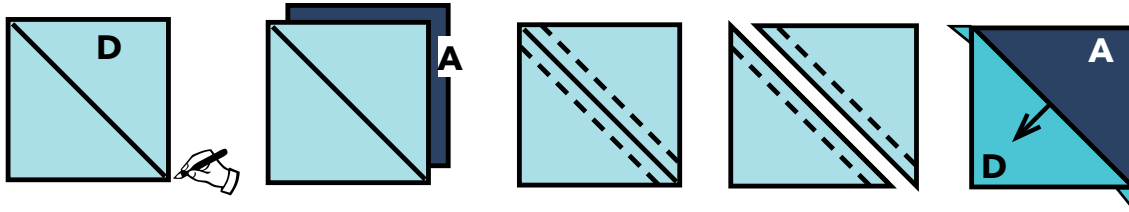

Use Two 4 1/8" Fabric B and D squares from Half Square Triangle Bag.

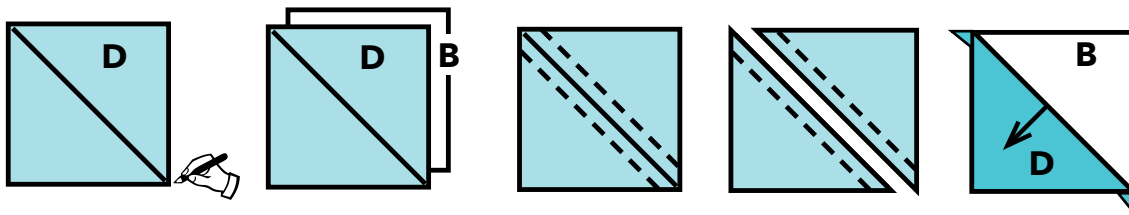

Trim to Four 3 1/2" squares of each.

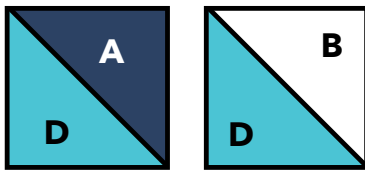
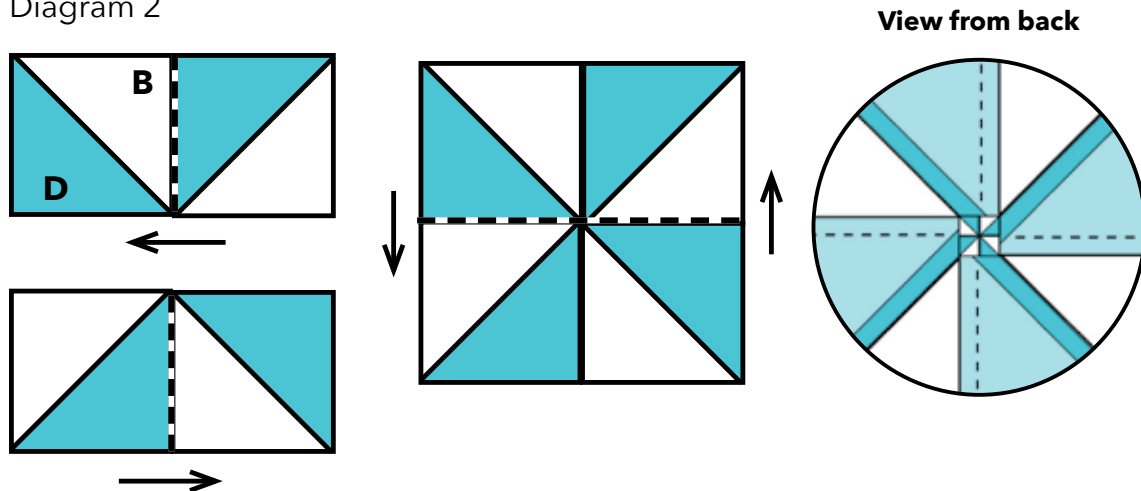

Diagram 2



# Walking Star Quilt Block

Diagram 3

Use Four 3 1/2" Fabric B and D squares and Four 3 1/2" x 6 1/2" Fabric A rectangles from Flying Geese Bag.

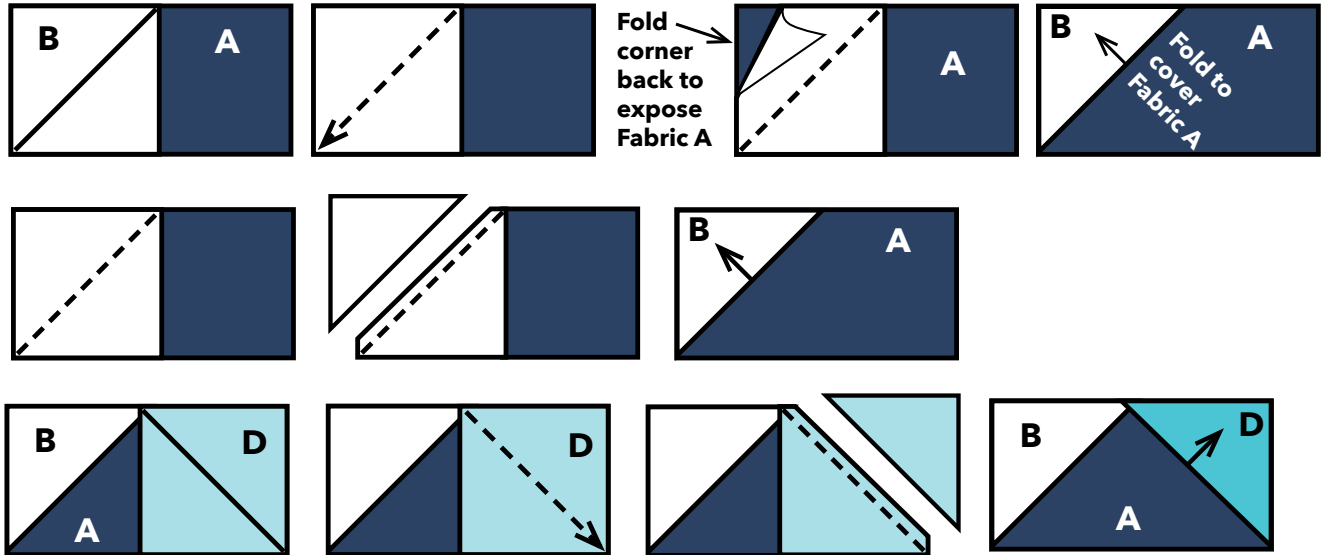
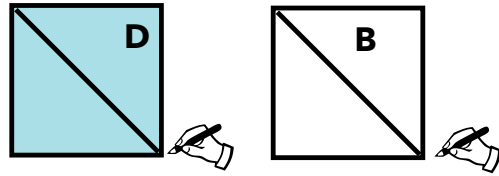

Diagram 4

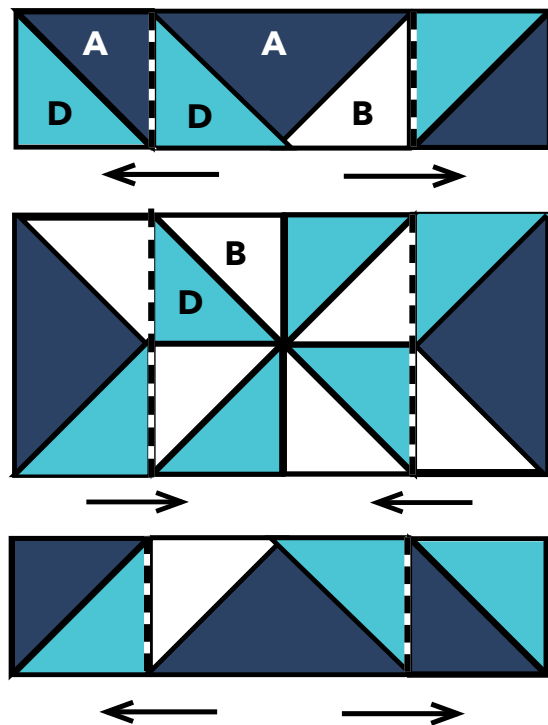

Diagram 5

