

Kansas Star Quilt Block

Star Quilt Block of the Month Block #5 Kansas Star

NOTE: Lighter shade of color indicates wrong side of fabric.

Diagram 1

Use Twenty $2\frac{1}{2}$ " Fabric A squares, Four $4\frac{1}{2}$ " Fabric B squares, and One $4\frac{1}{2}$ " Fabric C square from Square in a Square Bag.

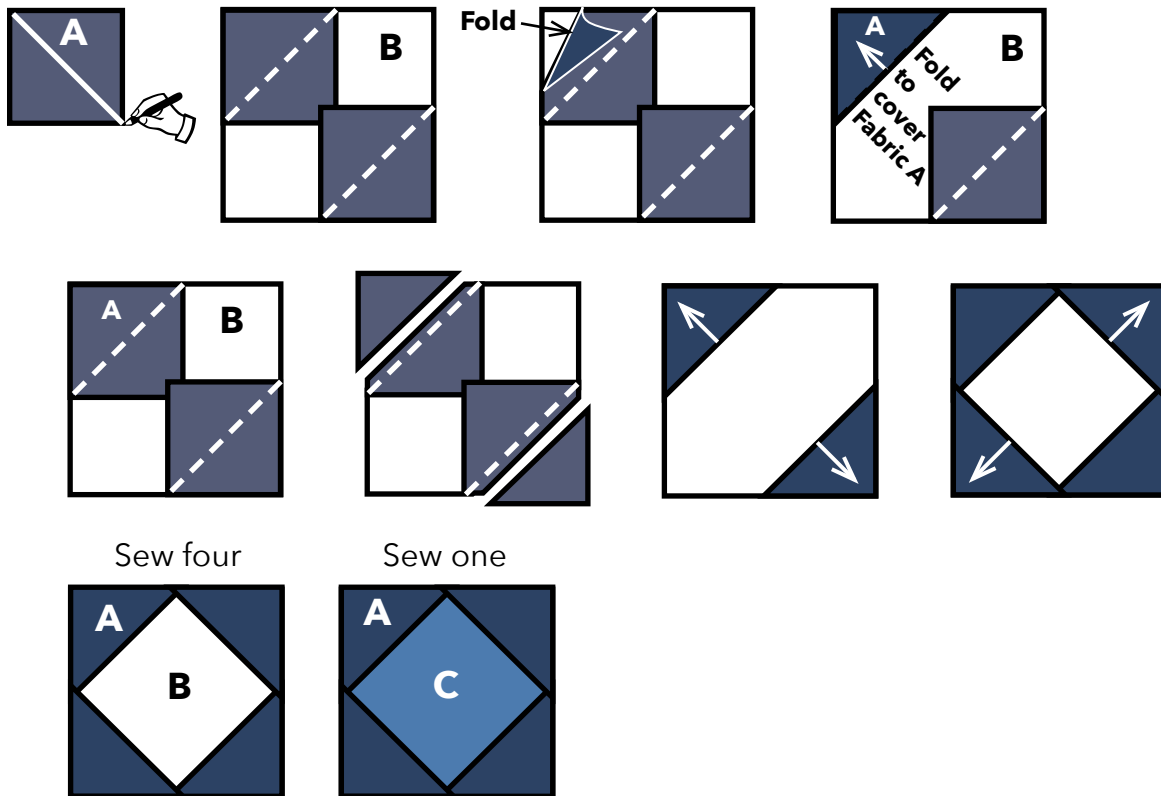
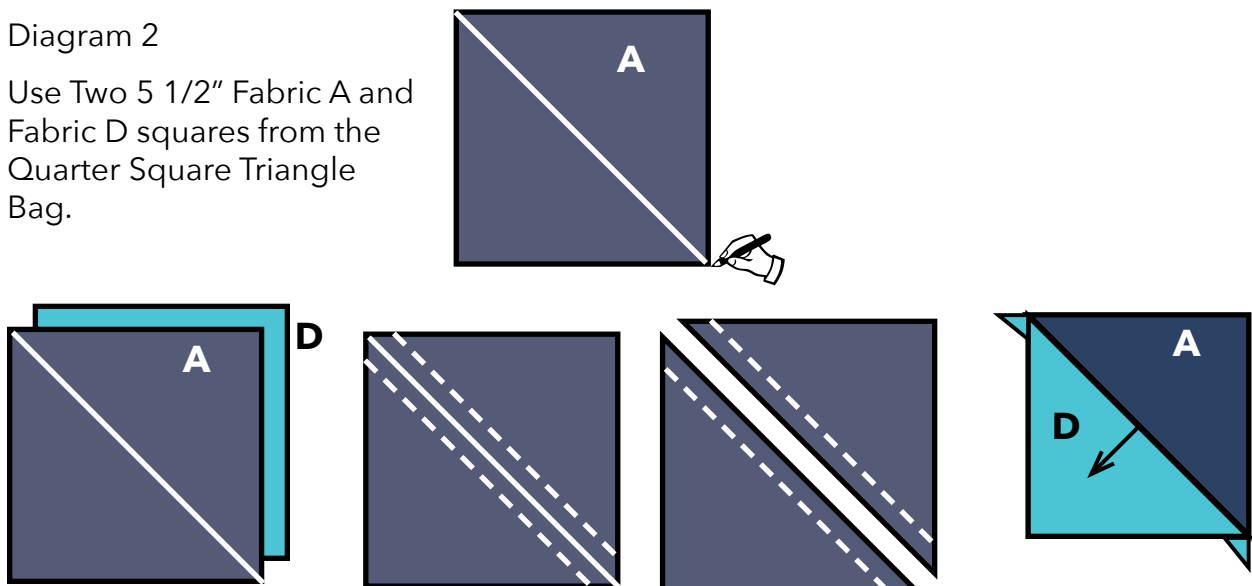

Diagram 2

Use Two $5\frac{1}{2}$ " Fabric A and Fabric D squares from the Quarter Square Triangle Bag.



Kansas Star Quilt Block

Diagram 3

NOTE: Fabric A is shown as white for a more clear view of pressing.

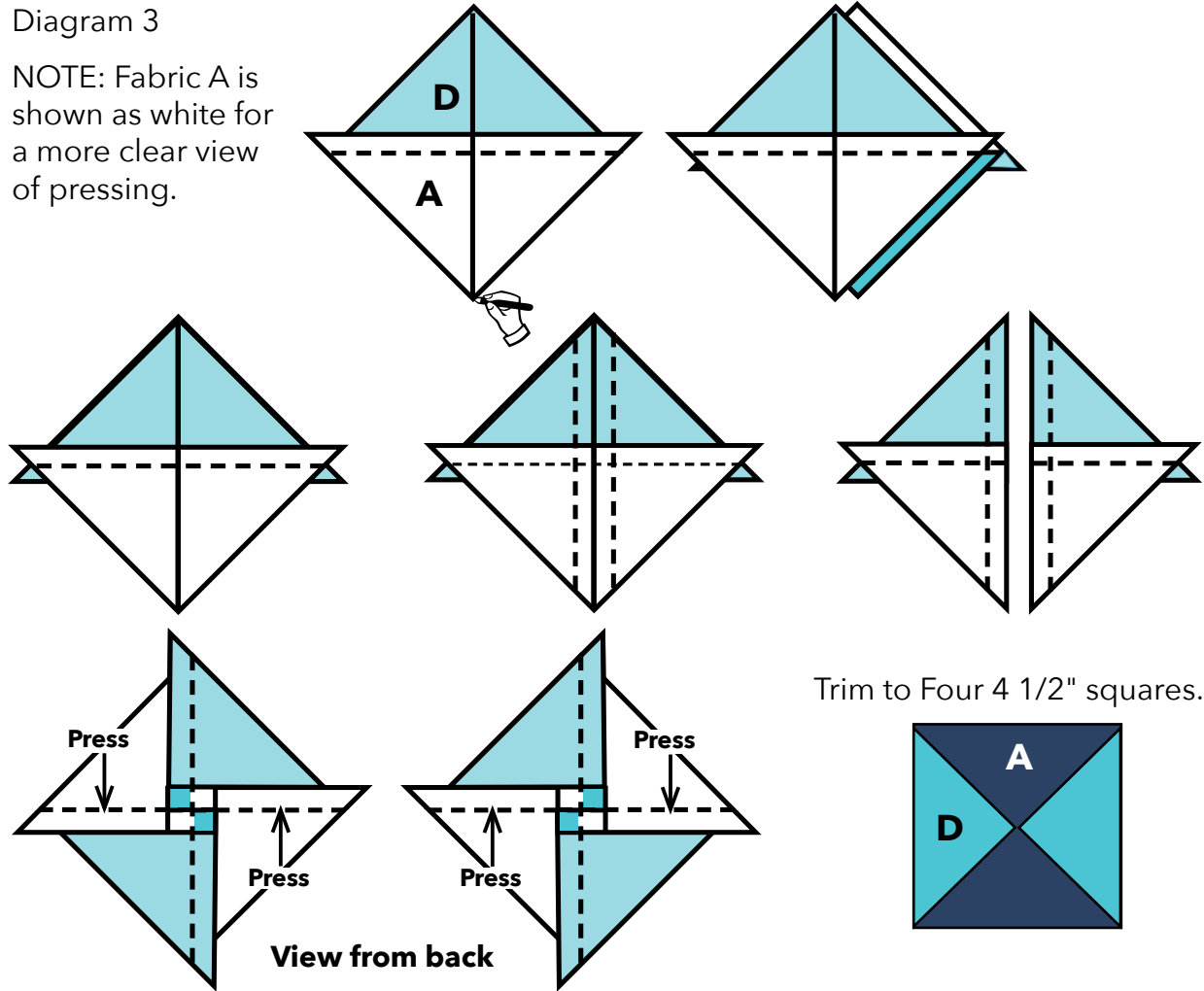

Diagram 4

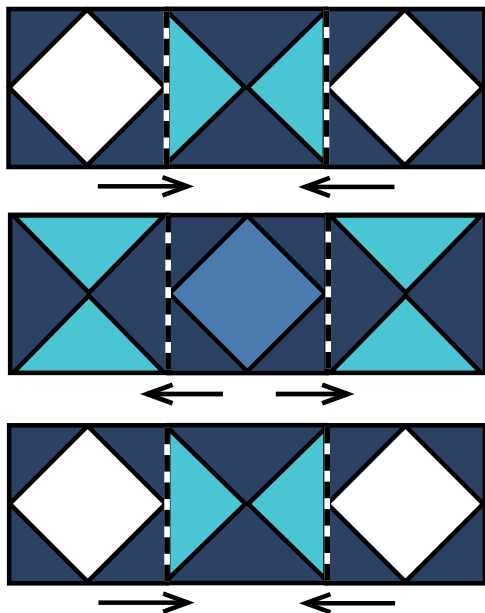

Diagram 5

