

## Diamond Star Quilt Block

Star Quilt Block of the Month Block #11 Diamond Star

NOTE: Lighter shade of color indicates wrong side of fabric.

Diagram 1

Use Four 2 1/2" Fabric E and B squares, One 4 1/2" Fabric C square, and Four 4 1/2" Fabric A squares from Square in a Square Bag.

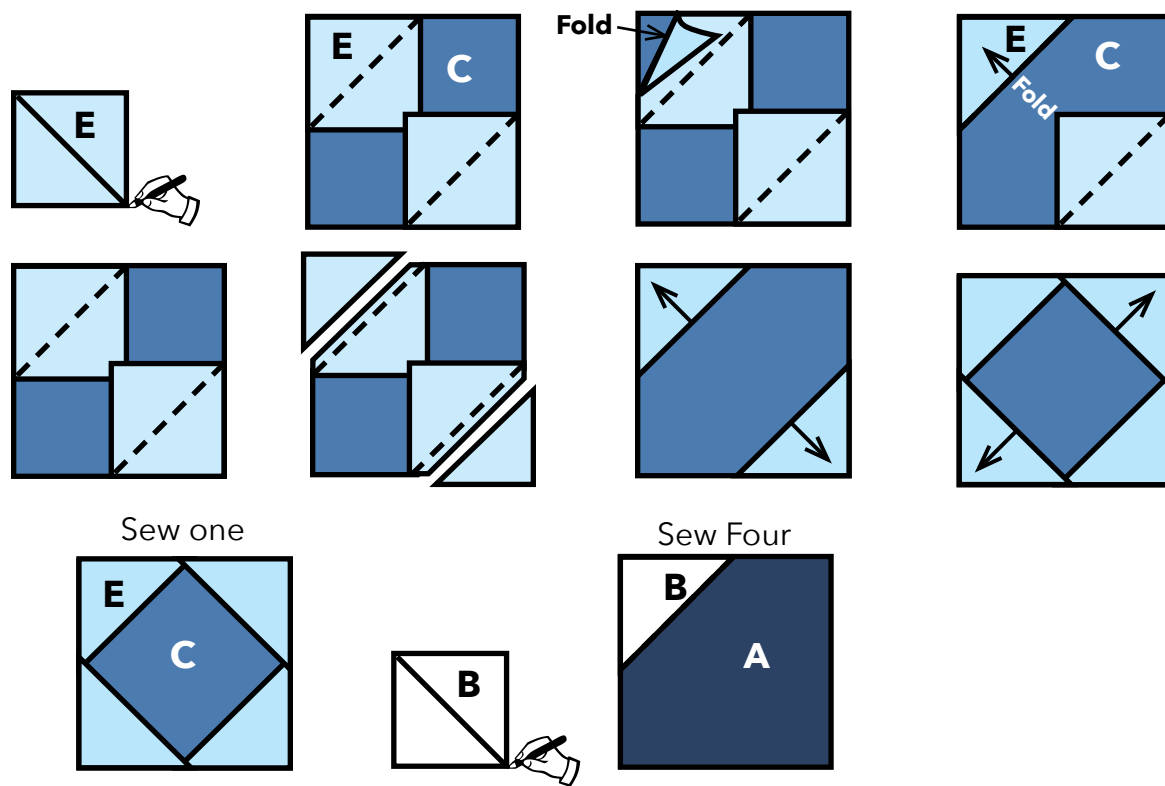
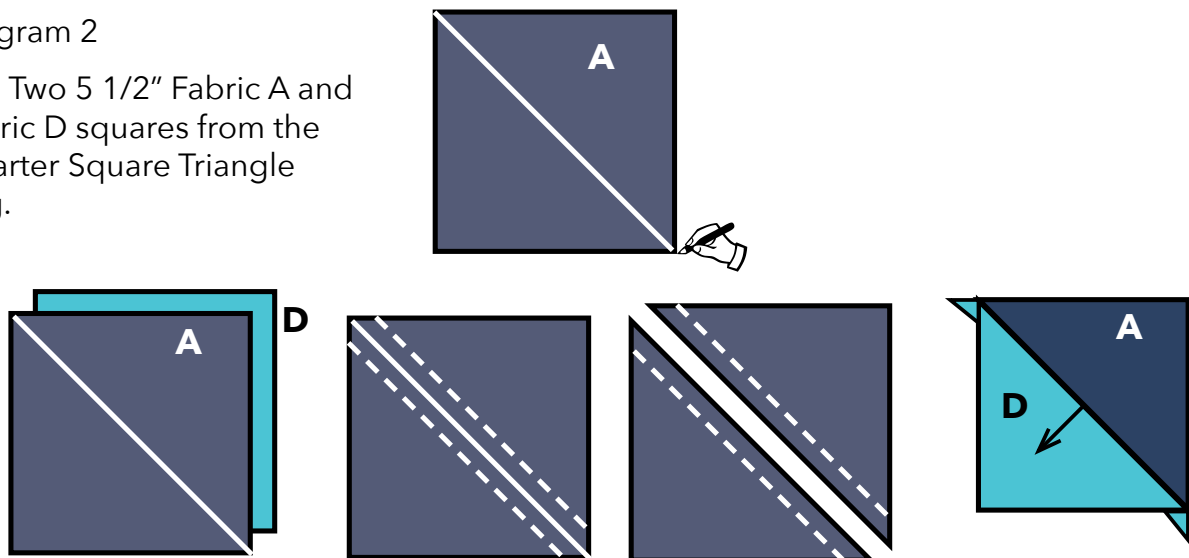

Diagram 2

Use Two 5 1/2" Fabric A and Fabric D squares from the Quarter Square Triangle Bag.



# Diamond Star Quilt Block

Diagram 3

NOTE: Fabric A is shown as white for a more clear view of pressing.

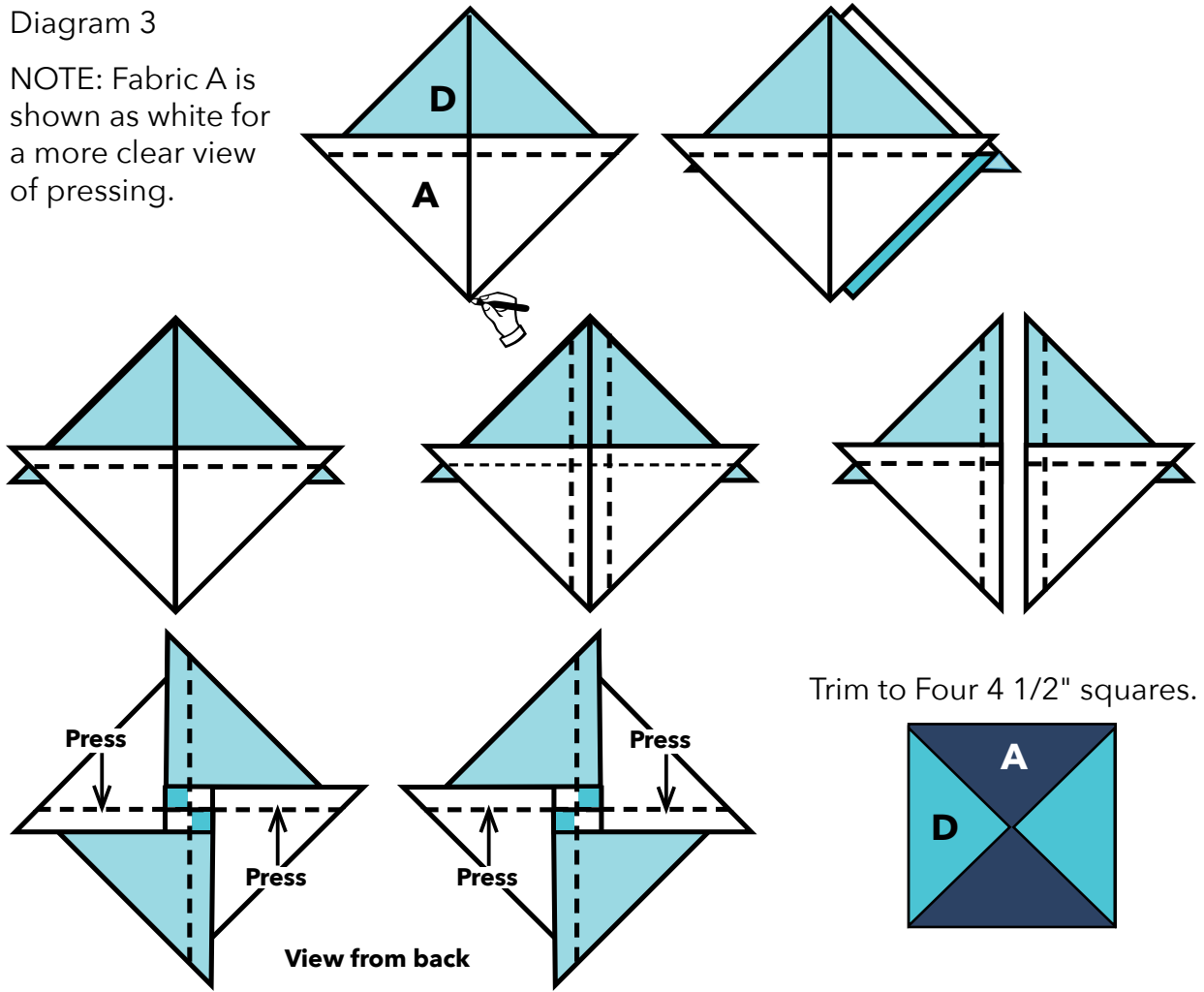

Diagram 4

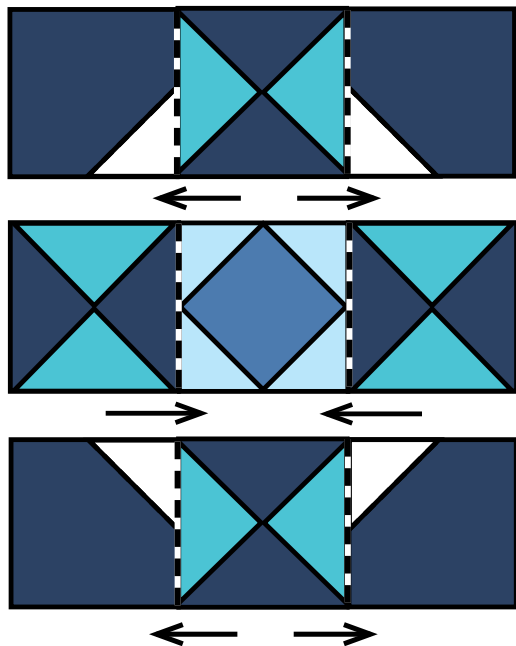

Diagram 5

