

Mother's Star Quilt Block

Star Quilt Block of the Month Block #10 Mother's Star

NOTE: Lighter shade of color indicates wrong side of fabric.

Diagram 1

Use Two $4 \frac{7}{8}$ " Fabric A squares, Two $4 \frac{7}{8}$ " Fabric C squares, and Four $2 \frac{1}{2}$ " Fabric D Squares from Half Square Triangle Bag.

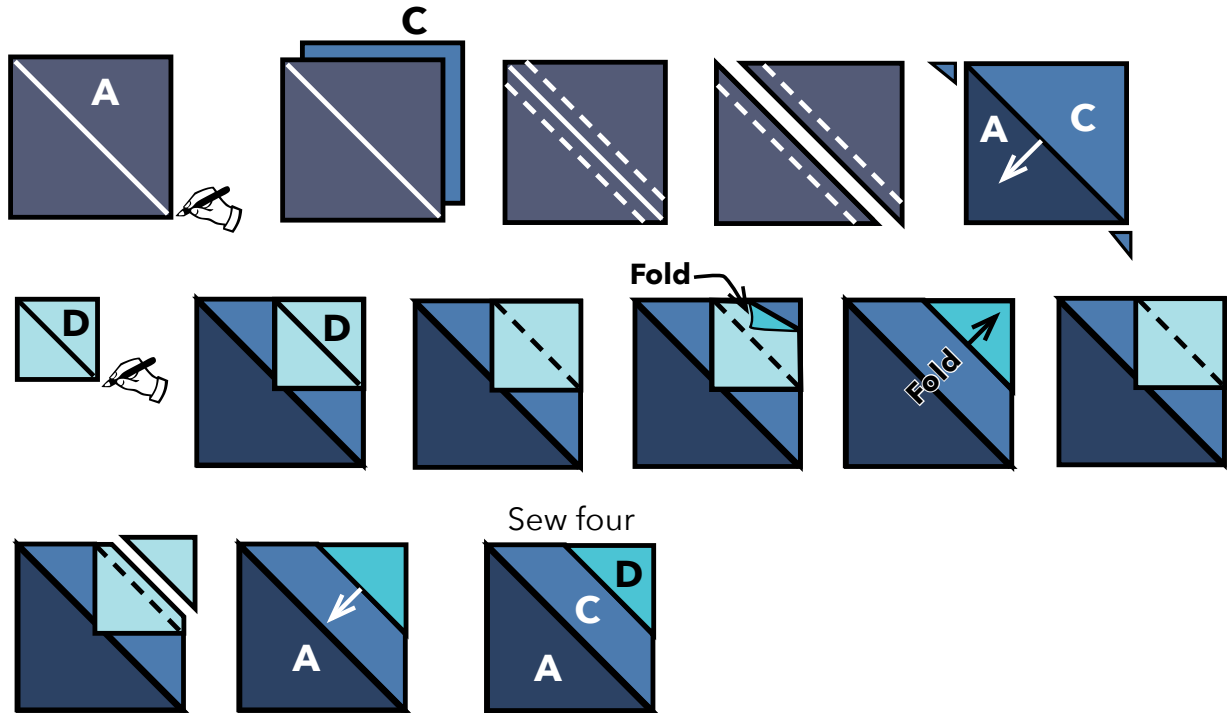
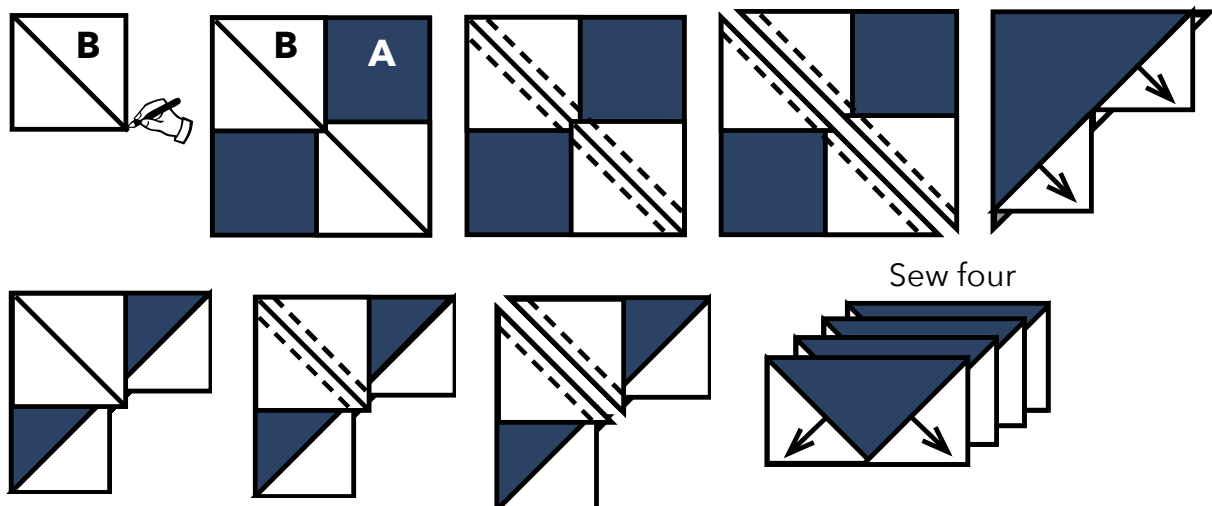

Diagram 2

Use One $5 \frac{1}{4}$ " Fabric A square and Four $2 \frac{7}{8}$ " Fabric B squares from Flying Geese Bag.



Mother's Star Quilt Block

Diagram 3

Use remaining 5 1/4" Fabric A square and Four 2 7/8" Fabric E squares from Flying Geese Bag.

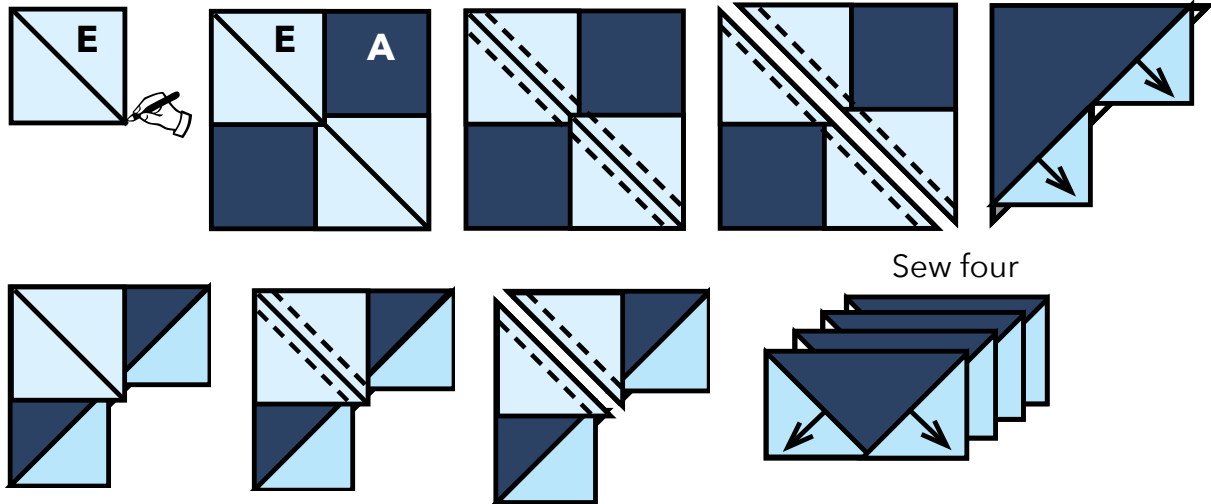

Diagram 4

Sew Four

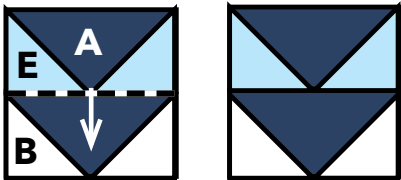

Diagram 5

Use 4 1/2" Fabric D square from Finishing Bag.

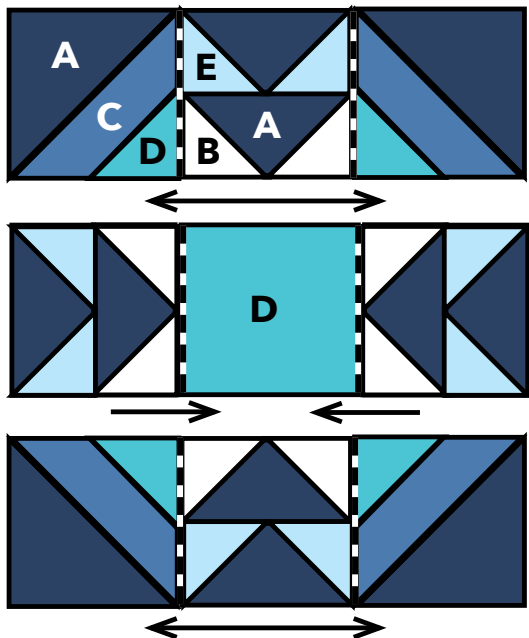

Diagram 6

