

# Pinwheel Star Quilt Block

## Star Quilt Block of the Month Block #1 Pinwheel Star

Diagram 1

Use  
Two 4 7/8"  
Fabric D  
squares and  
Two 4 7/8"  
Fabric A  
Squares.

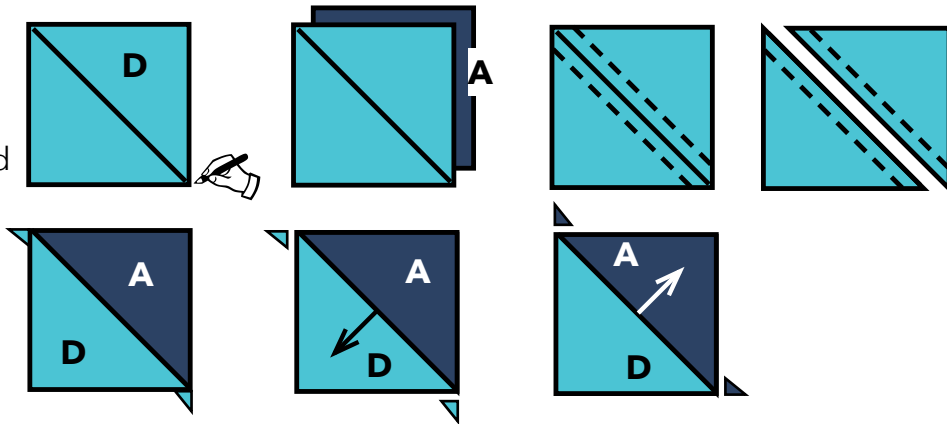

Diagram 2

Two 4 7/8"  
Fabric E  
squares  
and Two  
4 7/8"  
Fabric A  
Squares.

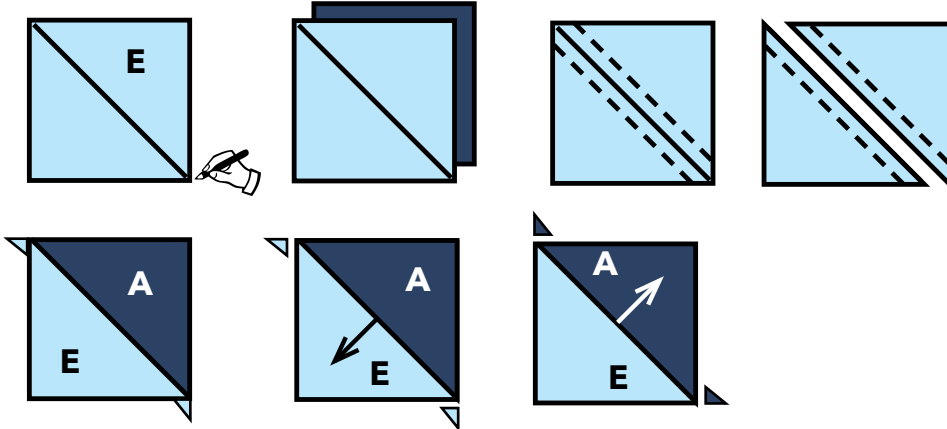

Diagram 3

Use 4 1/2"  
Fabric C  
square for  
center.

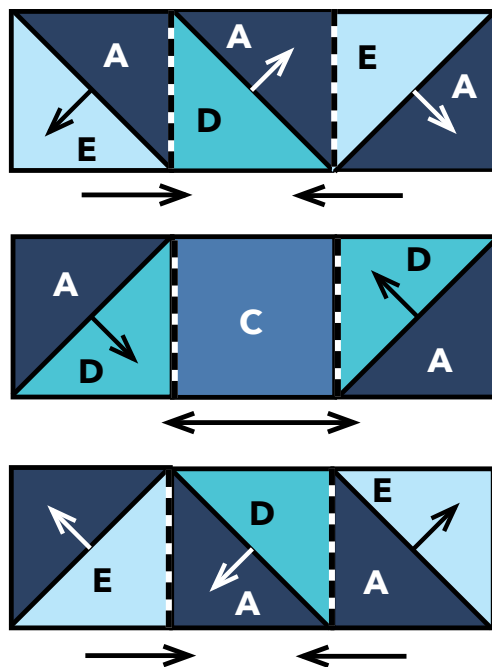

Diagram 4

