

Ribbon Star Quilt Block

Star Quilt Block of the Month Block #8 Ribbon Star

NOTE: Lighter shade of color indicates wrong side of fabric.

Diagram 1

Use 6 7/8" Fabric C and D squares, and Two 4 1/2" Fabric C and D squares from Center Square Bag.

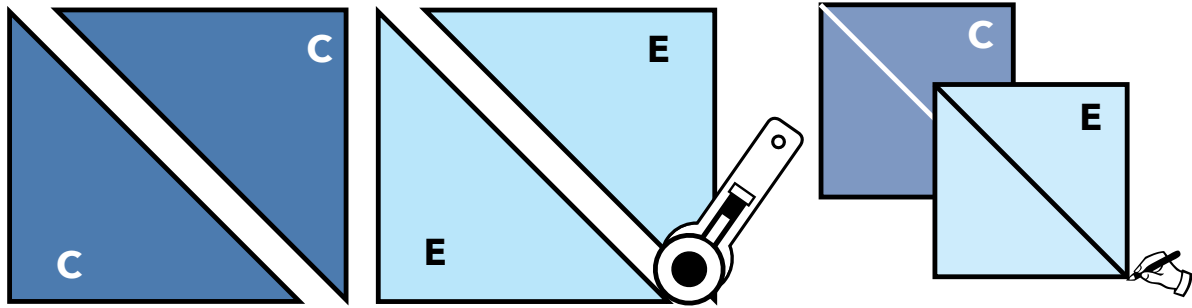
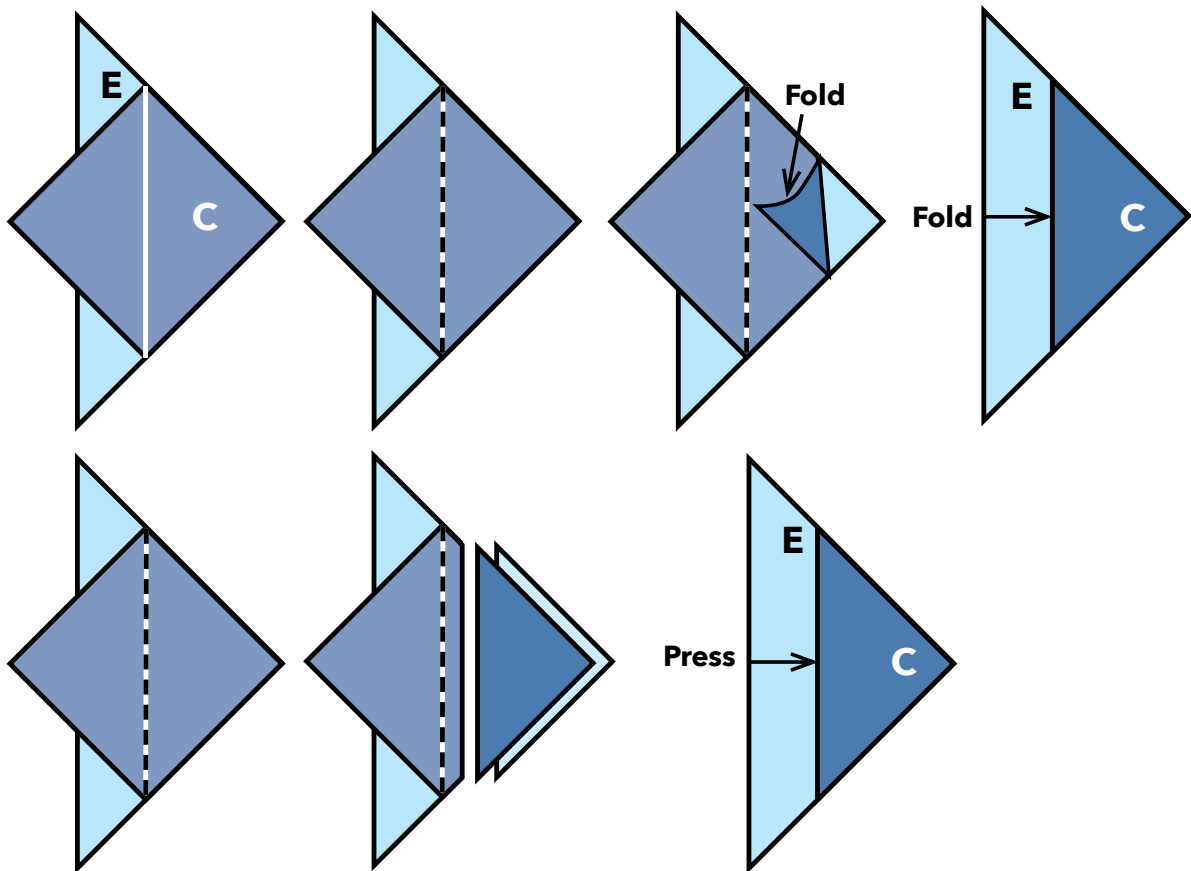

Diagram 2

Use Two Fabric E Triangles and Two Fabric C marked squares.



Ribbon Star Quilt Block

Diagram 3

Use Two Fabric C Triangles and Two Fabric E marked squares.

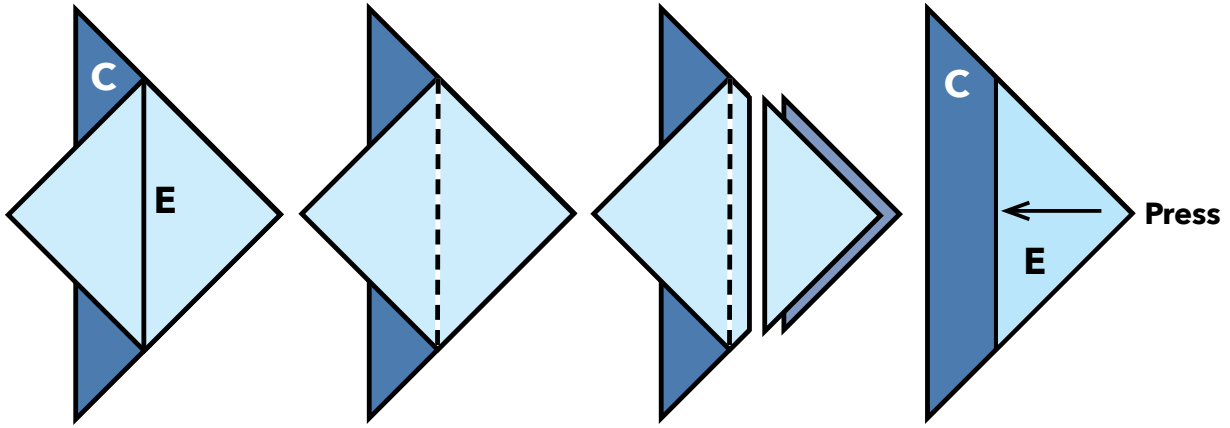

Diagram 4

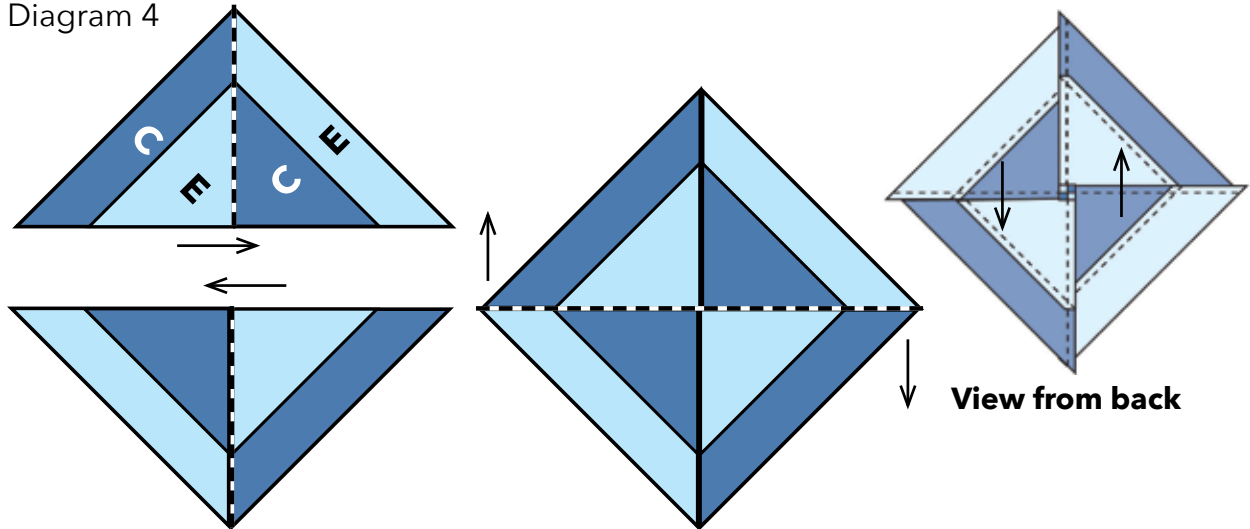
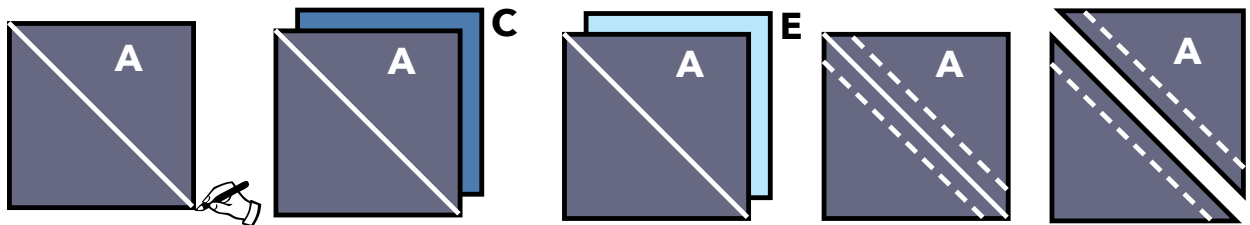

Diagram 5

Use Two 4 1/4" Fabric A squares, One 4 1/4" Fabric C square, and One 4 1/4" Fabric E square from Corner Flying Geese Bag.



Ribbon Star Quilt Block

Diagram 6

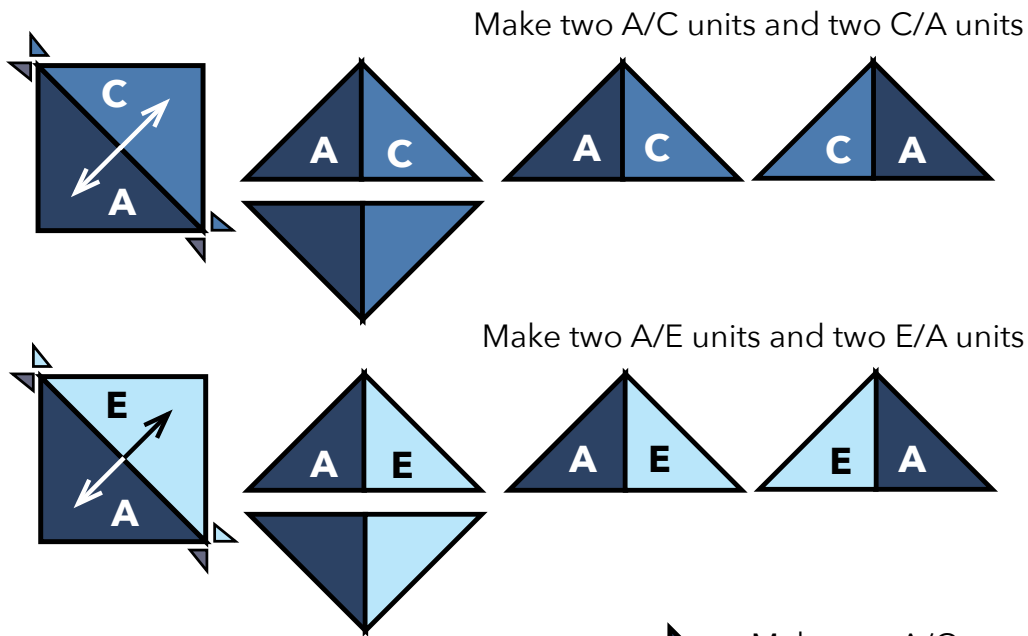
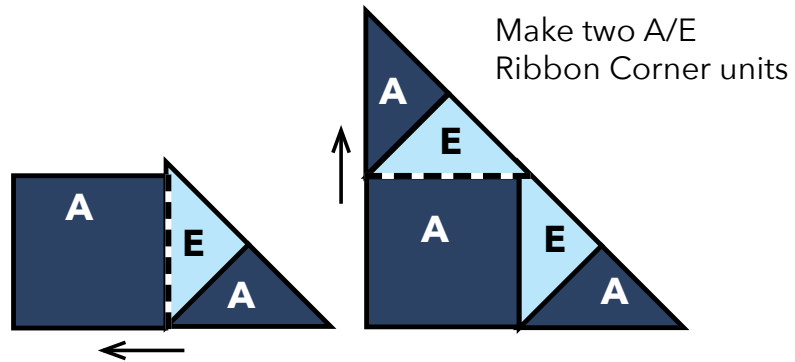
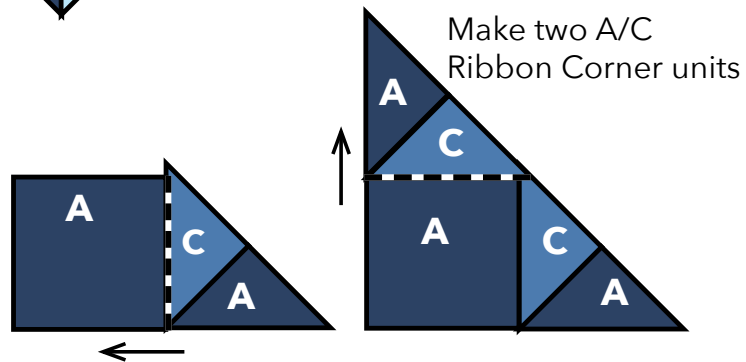

Diagram 7

Use Four 3 1/2" Fabric A squares from Ribbon Corner Bag.
Sew two of each unit.



Ribbon Star Quilt Block

Diagram 8

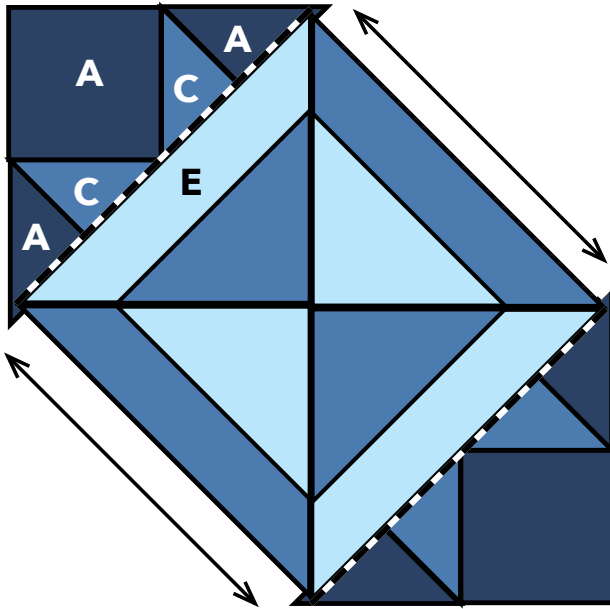

Diagram 9

